

REV	DESCRIPTION\PER REQUEST	DRAWN	DATE

- NOTES:
1. UNLESS OTHERWISE SPECIFIED ALL DIMENSIONS ARE IN MM.
  2. ALL SPECIFICATIONS ARE SUBJECT TO CHANGE WITHOUT NOTICE.

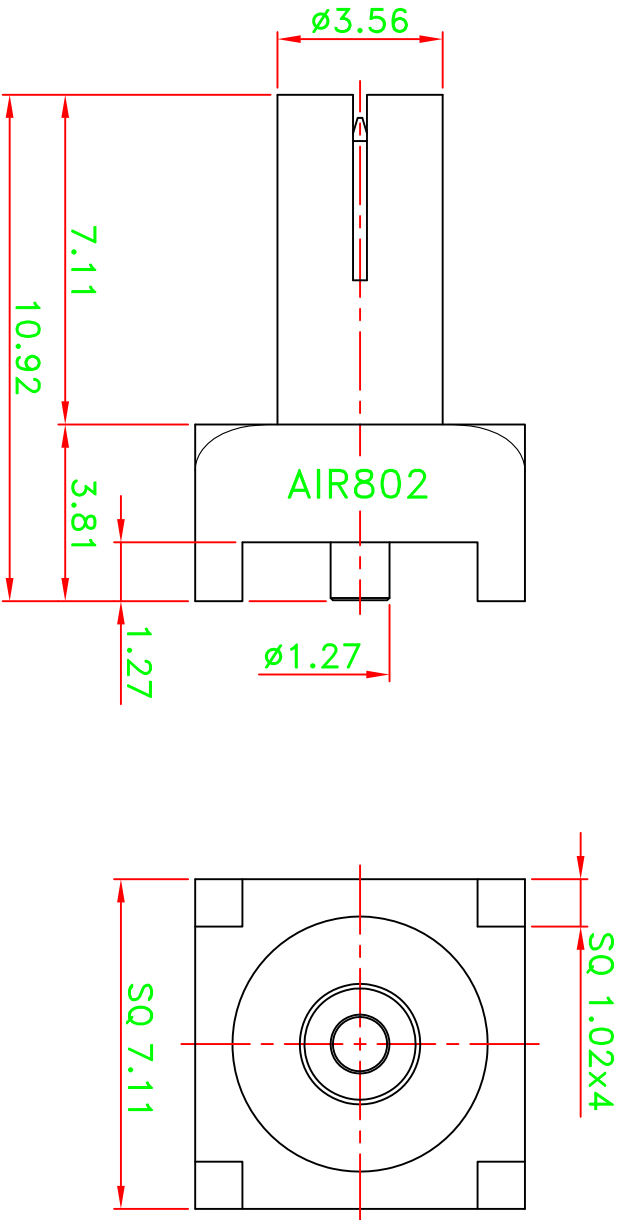

STAMP: AIR802

NO	DESCRIPTION/DRAWING NO.	Q'TY	MATERIAL	FINISH	PART NO.	APPROVED	DATE	* MAJOR DIMENSION	UNLESS OTHERWISE NOTED TOLERANCES	TITLE	FILE NO.	W.A.#	AS#	AS-#	TGG	REV	A
3	INSULATOR	1	PTFE	NATURAL	CNTS9PCB	M. Bryant	10/31/13	0.5-6 = $\pm 0.2$	6-30 = $\pm 0.4$	TS9 P.C. BOARD MOUNT PLUG	AS-23130-TGG	AS-23130-TGG	AS-23130-TGG	AS-23130-TGG	AS-23130-TGG	A	A
2	PIN	1	BRASS	GOLD			10/31/13	30-120 = $\pm 0.6$	120-315 = $\pm 1.0$								
1	BODY	1	BRASS	GOLD			10/31/13	ANGLES = $\pm 5^\circ$									

**AIR802 LLC**